

New

Essenza 8 SL PND II

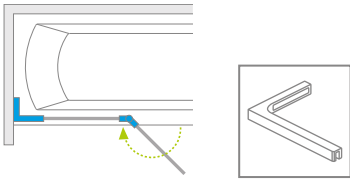

ADDITIONAL OPTIONS

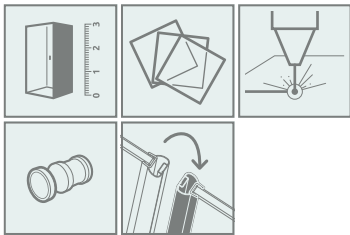

Profile finish:

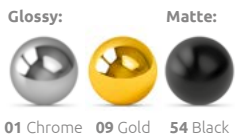

Brushed:



Other colour versions of products from the series can be found on p. 405



In the article number, the symbol **XX** should be replaced with the symbol of the selected colour: 91, 92, 93, 99.

Model	Width (X)	Height (H1)	TRANSPARENT GLASS			
			profile finish: CHROME Art. No.	profile finish: BLACK Art. No.	profile finish: GOLD Art. No.	profile finish: BRUSHED Art. No.
SL PND II 100 L	1000-1015	1506	10500100-01-01L	10500100-54-01L	10500100-09-01L	10500100- XX -01L
SL PND II 100 R	1000-1015	1506	10500100-01-01R	10500100-54-01R	10500100-09-01R	10500100- XX -01R
SL PND II 110 L	1100-1115	1506	10500110-01-01L	10500110-54-01L	10500110-09-01L	10500110- XX -01L
SL PND II 110 R	1100-1115	1506	10500110-01-01R	10500110-54-01R	10500110-09-01R	10500110- XX -01R
SL PND II 120 L	1200-1215	1506	10500120-01-01L	10500120-54-01L	10500120-09-01L	10500120- XX -01L
SL PND II 120 R	1200-1215	1506	10500120-01-01R	10500120-54-01R	10500120-09-01R	10500120- XX -01R
SL PND II 130 L	1300-1315	1506	10500130-01-01L	10500130-54-01L	10500130-09-01L	10500130- XX -01L
SL PND II 130 R	1300-1315	1506	10500130-01-01R	10500130-54-01R	10500130-09-01R	10500130- XX -01R
SL PND II 140 L	1400-1415	1506	10500140-01-01L	10500140-54-01L	10500140-09-01L	10500140- XX -01L
SL PND II 140 R	1400-1415	1506	10500140-01-01R	10500140-54-01R	10500140-09-01R	10500140- XX -01R

TECHNICAL DRAWINGS

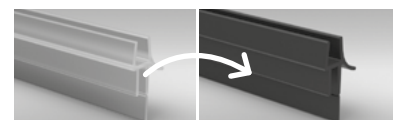
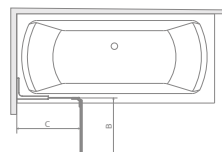
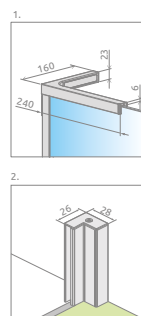
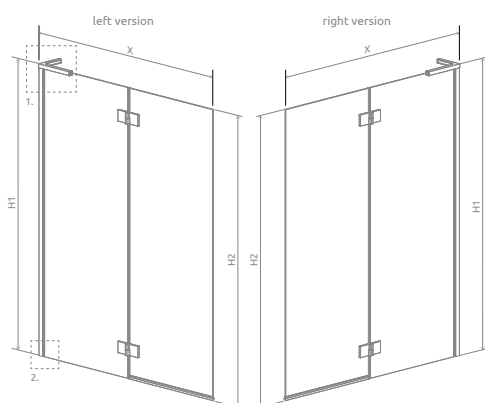

There is a possibility of a paid replacement of transparent gaskets (vertical and horizontal) for black gaskets. This option should be clearly stated in the order.

Model	X	B	C	H1	H2
PND II 100	1000-1015	486	535-550	1506	1500
PND II 110	1100-1115	536	585-600	1506	1500
PND II 120	1200-1215	586	635-650	1506	1500
PND II 130	1300-1315	636	685-700	1506	1500
PND II 140	1400-1415	686	735-750	1506	1500